



Sealeys
Walker ■ Jarvis

(01474) 369368



26 Harmer Street
Gravesend, DA12 2AX
£550 PCM



- AFFORDABLE ONE ROOM OFFICE.
- BUSINESS CENTRE WITH ENTRY PHONE.
- LOCATED ON ONE-WAY SYSTEM. PRICE INCLUDES BUSINESS RATES, ELECTRIC, HEATING AND WATER

Full Description

RENT

£550 PER CALENDAR MONTH rent includes water and electricity.

LOCATION DESCRIPTION

Located on the one-way system around Gravesend town centre is this modern and light ground office on the approach to the town's clock tower.

PROPERTY DESCRIPTION

A single room office of 10.73 SqM (115 Sq Ft) set within a small business centre located in Harmer Street, on Gravesend's busy one way system on the approach to the Clock Tower. A license to let is available by negotiation.

CURRENT BUSINESS RATES

Interested parties are advised to seek clarification from the local authority.

CURRENT CLASS OF BUSINESS USE

The current class of business use is an 'E' Category Use. Interested parties are advised to seek clarification of permitted use from the local authority.

ENERGY PERFORMANCE CERTIFICATE

EPC is not required as the property is a listed building.

Floor Plan

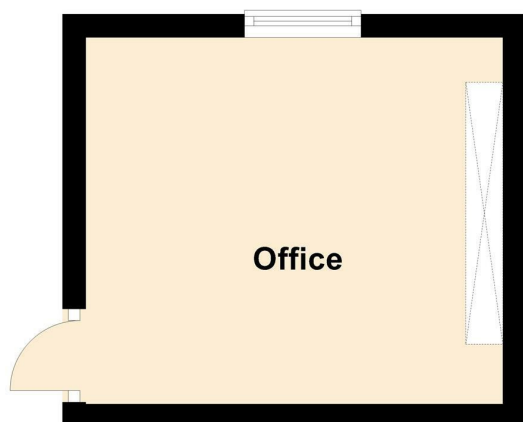

Energy Efficiency Graph

Viewing

Please call our Commercial Department on (01474) 369368 or Email: commercial@sealeys.co.uk if you would like to arrange a viewing for this property or require further information.

Sealeys Walker Jarvis
184 Parrock Street
Gravesend
Kent
DA12 1EN
www.sealeys.co.uk

Agents Note: Whilst every care has been taken to prepare these marketing particulars, they are for guidance purposes only. These details, description and measurements do not form part of a contract and whilst every effort has been made to ensure accuracy this cannot be guaranteed. Interested parties must satisfy themselves by inspection or otherwise as to the correctness of them. Floor plans are not to scale and are for illustration purposes only. Any equipment, fixtures and fittings or any item referred to have not been tested unless specifically stated.